

specter

SPECTER STANDARD MODULES
BREAK DOT

bold
lighting



BREAK DOT

Our Magnetic track system, SPECTER, is a highly configurable, 2 circuits, 24VDC low voltage track system. Thanks to its magnet mounting technology, the modules are inter-changeable instantaneously. Our track is available in ceiling pendant, surface and recessed mounting for both ceiling and walls. SPECTER track is also available with an optional linear uplight feature. The BREAK module offers a wide range of optics along with a tilt up to 90° allowing the illumination of both horizontal or vertical planes.

- ☐ Up to 1532lm delivered output
- ☐ Available in 3 sizes, 3", 6" and 12"
- ☐ Adjustable tilt to 90°
- ☐ Available in low glare baffles
- ☐ 3 beam options, narrow, medium and wide
- ☐ Fixtures designed to mount in SPECTER track
- ☐ For fixture dimming refer to track driver specifications¹
- ☐ Available in 4 standard finishes: Black, white, silver and bronze
- ☐ Standard black baffles, custom colors are available upon request. Consult factory for adder cost and lead-times

Notes: ¹ Dimming options, 0-10V, ELV and DALI

Code example: **SPSF-B**03W-**B**-N927-2

Series	Length		Body Finish		Baffle Finish		Beam Angle		CRI	Color Temp		Circuit	
SPSF-B	03	3"	W	White	B	Black	N	12°	9 +90	27	2700K	1	1-Circuit
	06	6"	B	Black	X	Custom	M	24°		30	3000K	2	2-Circuit
	12	12"	S	Silver			F	36°		35	3500K		
			Z	Bronze						40	4000K		
			X	Custom									

STANDARD FINISHES

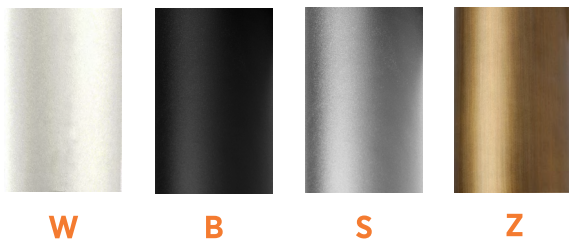

DELIVERED LUMEN OUTPUT

Length		Watts	CRI +90			
			2700K	3000K	3500K	4000K
3"	4W		326lm	363lm	399lm	439lm
6"	8W		539lm	599lm	659lm	725lm
12"	16W		1139lm	1266lm	1393lm	1532lm



Bold Lighting
4710 Ecton Dr., Marietta, GA 30066, USA
info@boldlighting.us www.boldlighting.us
t: +1-678-903-4061

Photometric data: Type C Polar Curves

12° Beam Angle

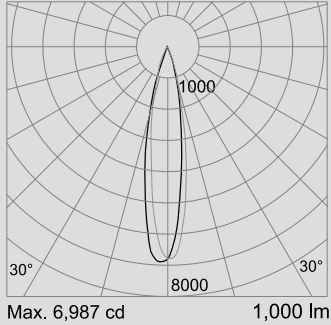

24° Beam Angle

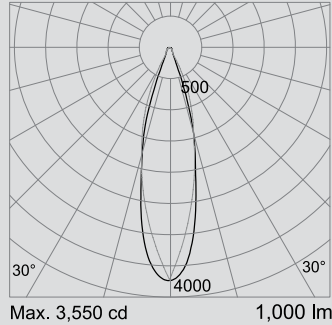

36° Beam Angle

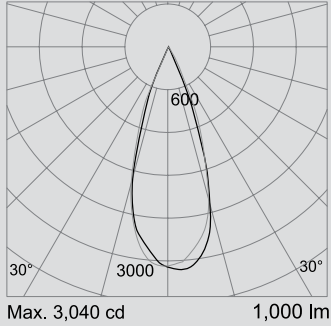

BREAK 3

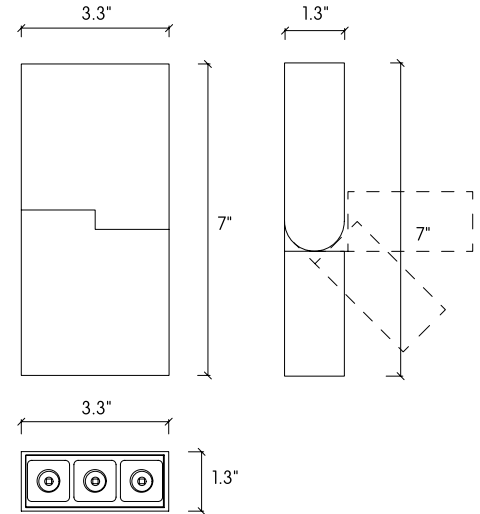

BREAK 6

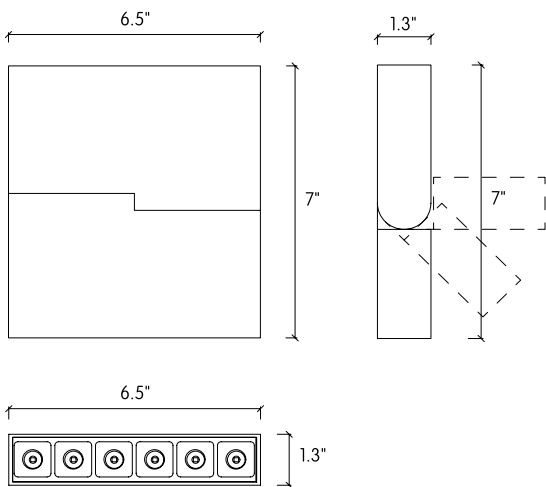

BREAK 12

