

INSTALLATION MANUAL OUTDOOR SURFACE MOUNTED

INDEX

- 1: INSTALLATION CONDITIONS

2: CABLE & CONDUIT INSTALLATION

3: WIRING INSTRUCTIONS

4: CONTINUOUS RUN INSTALLATION



WARNING:

The safety of this fixture is guaranteed only if you comply with these instructions.

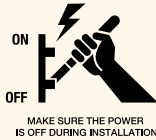

IP65

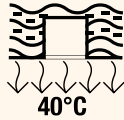

THE LOW SURFACE TEMPERATURE (40°C) IMPOSE NO LIMITS ON INSTALLATION



1. INSTALLATION CONDITIONS

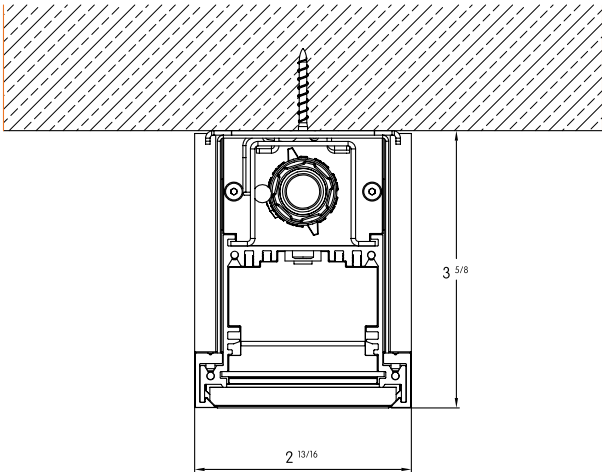

Prepare the ceiling conditions according to the dimension table

Porfile Sizes (mm)				Profile Sizes (ft)			
Profile Exact Dimensions (mm)				Profile Exact Dimensions (ft)			
Length	Width	Depth		Length	Width	Depth	
300	N/A	N/A	N/A	1	N/A	N/A	N/A
600	622	72	92	2	2ft 1/2in	0ft 2 13/16 in	0ft 3 5/8 in
750	772	72	92	2 1/2	2ft 6 3/8in	0ft 2 13/16 in	0ft 3 5/8 in
900	922	72	92	3	3ft 5/16in	0ft 2 13/16 in	0ft 3 5/8 in
1050	1072	72	92	3 1/2	3ft 6 3/16in	0ft 2 13/16 in	0ft 3 5/8 in
1200	1222	72	92	4	4ft 1/8in	0ft 2 13/16 in	0ft 3 5/8 in
1350	1372	72	92	4 1/2	4ft 6in	0ft 2 13/16 in	0ft 3 5/8 in
1500	1522	72	92	5	4ft 11 15/16in	0ft 2 13/16 in	0ft 3 5/8 in

2. CABLES AND CONDUIT INSTALLATION



WARNING: Shock hazard. Serious injury or death may occur. Turn Off power before servicing or installing. Wire according to local and national codes. This product shall be installed by a qualified electrician.

1.

- ▶ Insert the main electric cable into the jack box.
- ▶ Fix the SM rot-bracket to the surface using the specified screw and washer while fixing the safety cable to the rot-bracket.

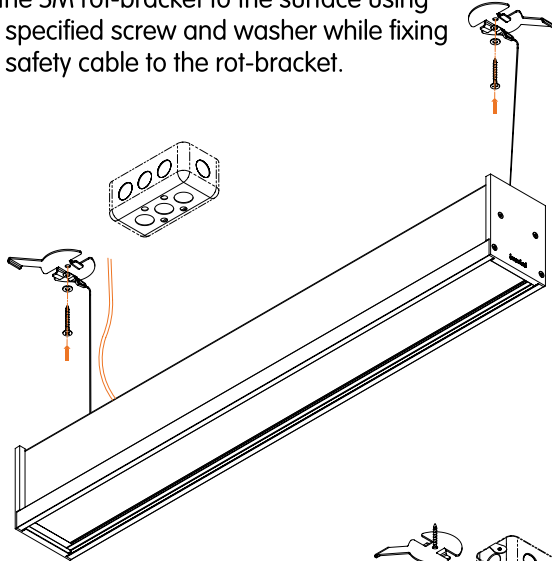

2.

- ▶ Put the profile on the rot-bracket where its dedicated whole.
- ▶ Then rotate the rot bracket so it locks the profile.

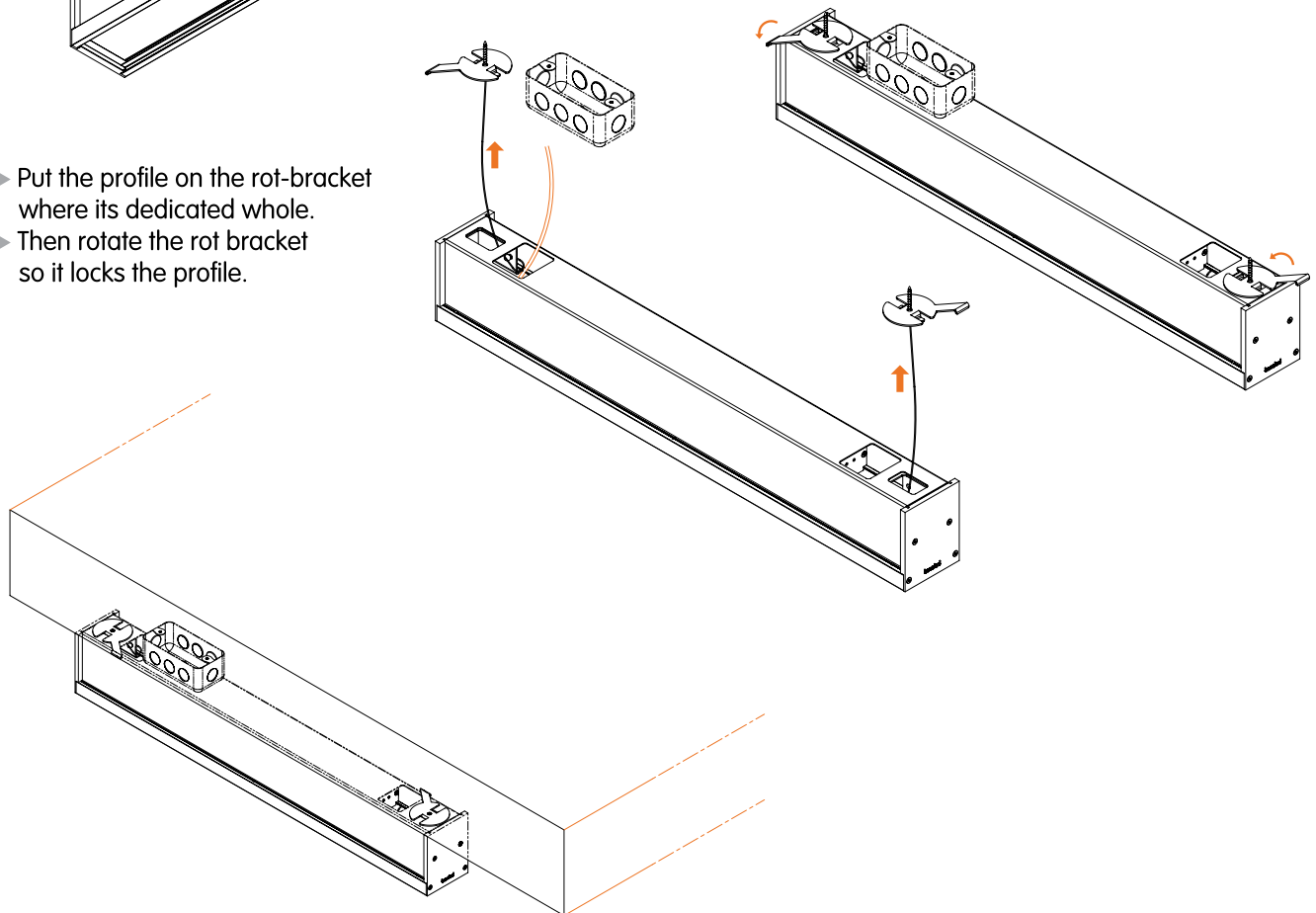

WARNING: Failure to secure safety cables can lead to injury or death!

3. WIRING INSTRUCTIONS

- Refer to the last page for wiring instructions.
- Follow carefully wiring diagram for various dimming protocols.
- Before beginning the wiring process, double check the type of connection specified.

T1 Type fixture only have an input, and cannot be used for daisy chained fixtures.

CONTINUOUS RUNS

T2 Type fixtures have through wiring and are meant to be daisy chained.

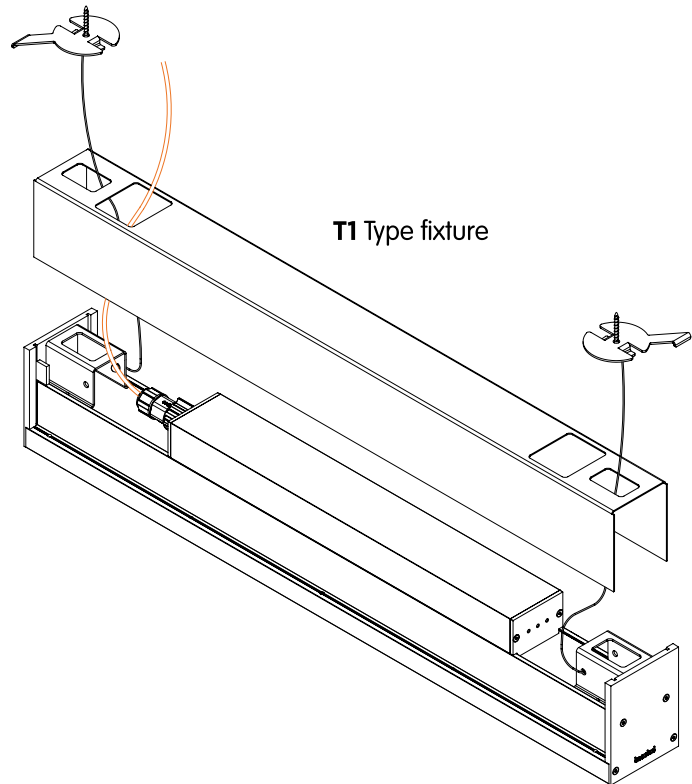

Wiring Color Codes

	Ground	Line	Neutral	Dimmed Line	0-10V +	0-10V -	Dali +	Dali -
UL System	Green	Black	White	Orange	Red	Grey	Red	Orange
CE System	Yellow/Green	Brown	Blue	N/A	Red	Black	Red	Black

Wiring Instructions for continuous runs (Daisy Chained Fixtures)

Max daisy chain length (A minimum of 18 AWG or 0.752 mm is required)

System	Voltage	"L" Output	"S" Output	"H" Output	"W" & "T" Outputs
UL	120VAC - 60 Hz	100 ft.	50 ft.	36 ft.	50 ft.
	277VAC - 60 Hz	200 ft.	100 ft.	70 ft.	100 ft.
CE	240VAC - 50/60 Hz	45m	23m	17m	23m



WARNING: Do not exceed the rated wattage of the through wiring cables or the connectors.
For all continuous runs, refer to factory shop drawing indicating exact dimensions and feed locations.

4. CONTINUOUS RUN INSTALLATION

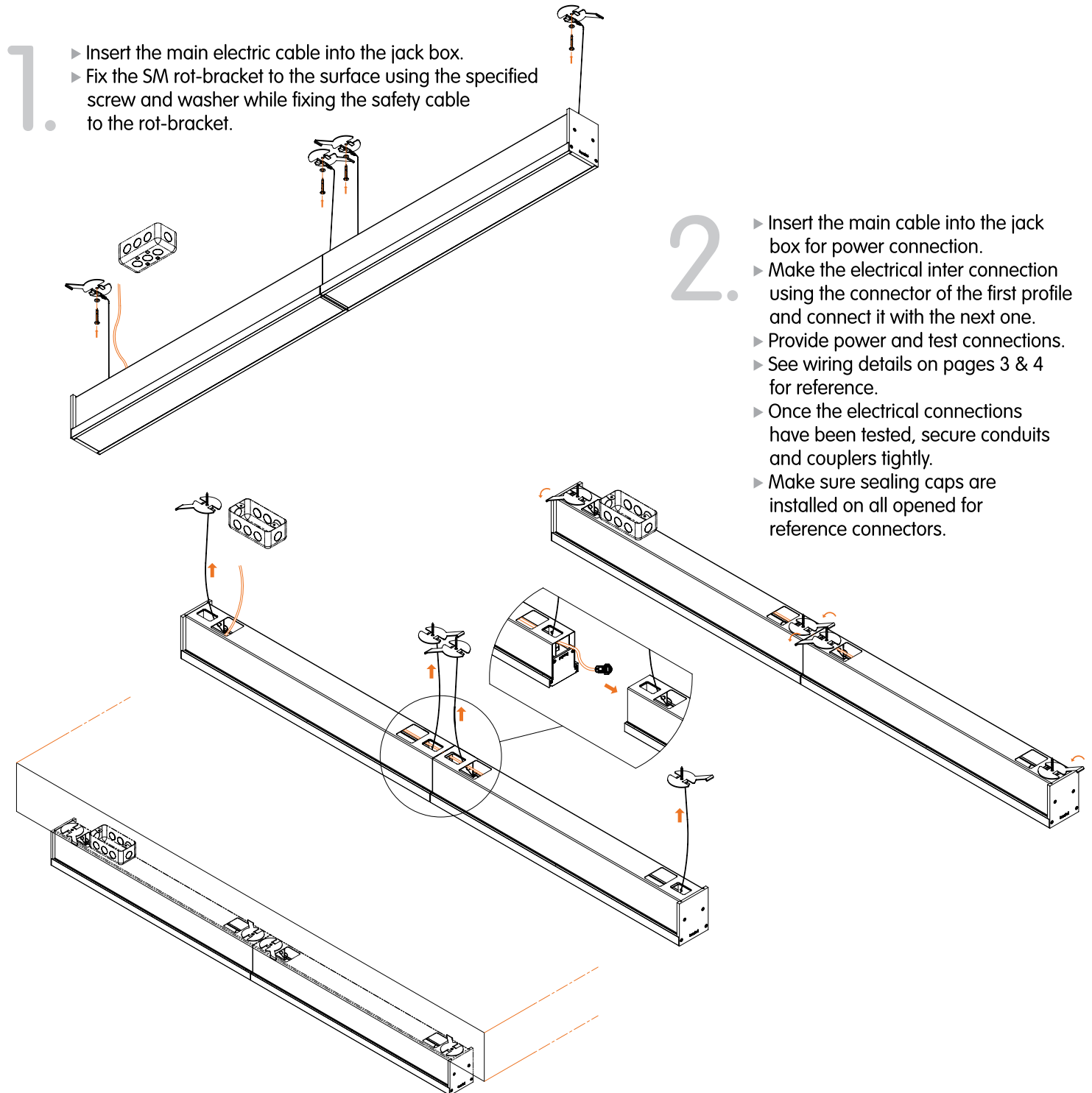

WARNING: Do not exceed the rated wattage of the through wiring cables or the connectors.
For all continuous runs, refer to factory shop drawing indicating exact dimensions and feed locations.

LINE-TO-LINE CONNECTOR:

When Provided with Line-to-Line Connectors, fixtures will be Type 2 (Daisy chained) as show on page 3 and will have an Input cable and an Output cable with specific length. These Cables shall be connected and terminated On-site.

Line-to-Line Connectors will have a separate instruction manual included in the fixture's packaging, giving detailed instructions on how to connect the leads properly. This step requires following the below wire labeling closely to prevent any damage to the fixtures.

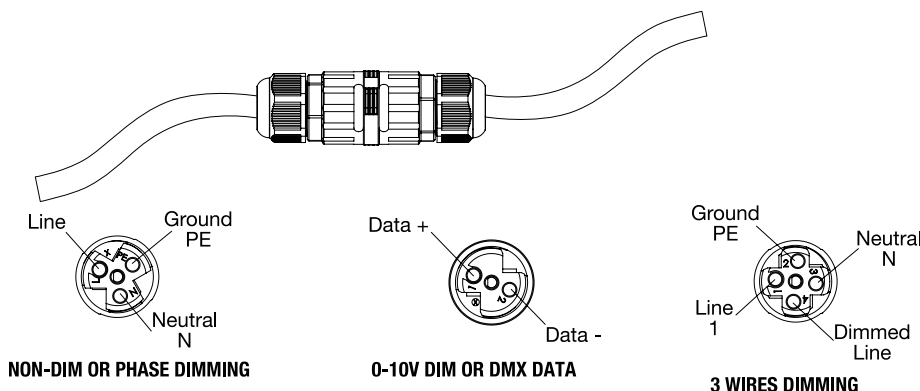

Warning: Failure to follow the wiring color coding and connectors pin labeling will void the fixtures warranty.

Warning: For 0-10v dimming, the fixture are provided with two (2) cable leads, one with a 3 pin connector for power and the other with 2 pins connector for dimming wires. follow below connector labeling for termination of wires.

MALE / FEMALE

When fixtures are ordered for continuous runs, (Daisy Chained), fixtures will be provided with MALE / FEMALE Connectors.

Connectors are factory installed on Input and Output cables leads.

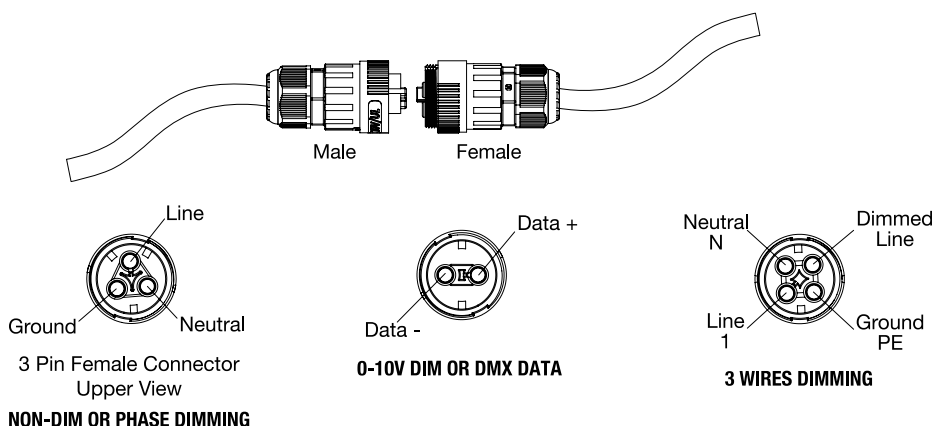

Warning: Failure to follow the wiring color coding and connectors pin labeling will void the fixtures warranty.

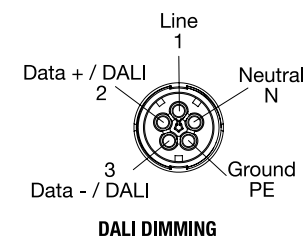

WARNING: The connectors pins labeling can be found inside connector, embossed on the wire terminals. Always double check factory wiring order before connecting terminating the cables on-site.