

INSTALLATION MANUAL OUTDOOR INGROUND

INDEX

- 1: INSTALLATION CONDITIONS
- 2: CABLE & CONDUIT INSTALLATION
- 3: HOUSING INSTALLATION
- 4: WIRING INSTRUCTIONS
- 5: CONTINUOUS RUN INSTALLATION

ON
OFF
MAKE SURE THE POWER IS OFF DURING INSTALLATION

IP67

40°C

THE LOW SURFACE TEMPERATURE (40°C)
IMPOSE NO LIMITS ON INSTALLATION

CAUTION
SLIPPING HAZARD

15 000 N

THE FITTINGS HAVE BEEN DESIGNED AND TESTED TO WITHSTAND A STATIC LOAD OF 10000 N (BASED ON THE OUTER CASING) FOR INSTALLATION EXCLUSIVELY IN PEDESTRIAN OR BICYCLE AREAS

IK 10

WARNING:
The safety of this fixture is guaranteed only if you comply with these instructions.

1. INSTALLATION CONDITIONS

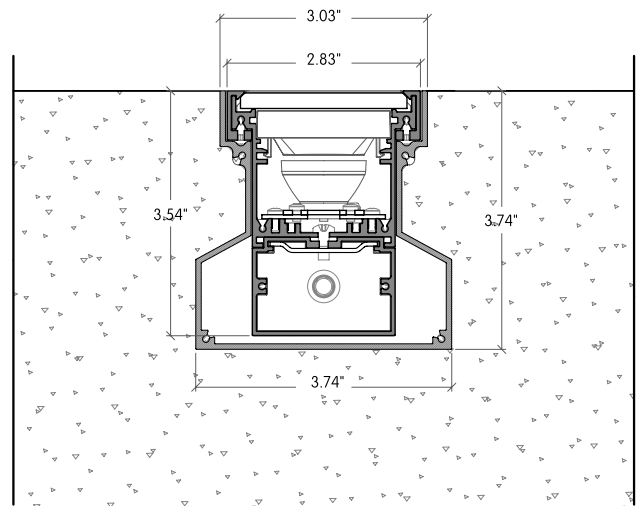
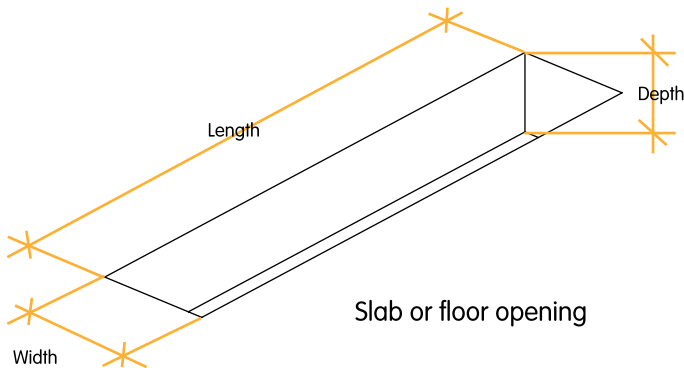

Prepare the ceiling conditions according to the dimension table

Profile Sizes (mm)				Profile Sizes (ft)			
Profile Exact Dimensions (mm)				Profile Exact Dimensions (ft)			
Length	Width	Depth		Length	Width	Depth	
300	325	95	92	1	1ft 13/16in	0ft 3 3/4 in	0ft 3 5/8 in
450	475	95	92	1 1/2	1ft 6 11/16in	0ft 3 3/4 in	0ft 3 5/8 in
600	625	95	92	2	2ft 9/16in	0ft 3 3/4 in	0ft 3 5/8 in
750	775	95	92	2 1/2	2ft 6 1/2in	0ft 3 3/4 in	0ft 3 5/8 in
900	925	95	92	3	3ft 3/8in	0ft 3 3/4 in	0ft 3 5/8 in
1050	1075	95	92	3 1/2	3ft 6 5/16in	0ft 3 3/4 in	0ft 3 5/8 in
1200	1225	95	92	4	4ft 3/16in	0ft 3 3/4 in	0ft 3 5/8 in
1350	1375	95	92	4 1/2	4ft 6 1/8in	0ft 3 3/4 in	0ft 3 5/8 in
1500	1525	95	92	5	5ft	0ft 3 3/4 in	0ft 3 5/8 in

WARNING:

Failure to provide proper drainage will void product warranty a proper water drainage system is required with a minimum rate of 0.087 gal (0.33 liter) per minute per meter according to the table:

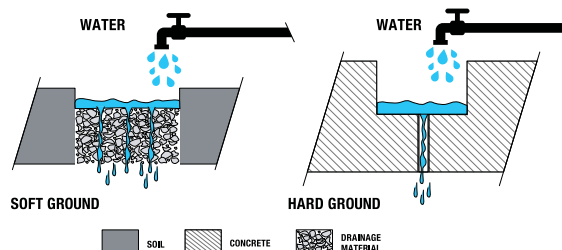

Length Minimum Drainage Rate

Length	Minimum Drainage Rate
1 ft (30cm)	0.026 gal/min (0.1 l/min)
2 ft (60cm)	0.053 gal/min (0.2 l/min)
3 ft (90cm)	0.079 gal/min (0.3 l/min)
4 ft (120cm)	0.105 gal/min (0.4 l/min)
5 ft (150cm)	0.132 gal/min (0.5 l/min)

2. CABLES AND CONDUIT INSTALLATION

- ▶ Locate Housing hole(s).
(Please note that continuous runs intermediate housing have holes at both ends for daisy-chain configurations).
- ▶ Lay down conduits.
- ▶ Tighten conduits loosely to the housing using couplers.
- ▶ Use conduits and couplers that are appropriate for your installation.
- ▶ Run the leader cable through conduits.
- ▶ Run jumper cables through the conduits.
- ▶ Leave enough cable length inside the housing to allow easy access from the top of the housing.
- ▶ Connect feed-in connector to lead
- ▶ Feed-in cable as per the instructions provided on page 4.
- ▶ Provide power and test connections.
- ▶ See wiring details on pages 3 & 4 for reference.
- ▶ Once the electrical connections have been tested, secure conduits and couplers tightly.
- ▶ Make sure sealing caps are installed on all opened connectors.

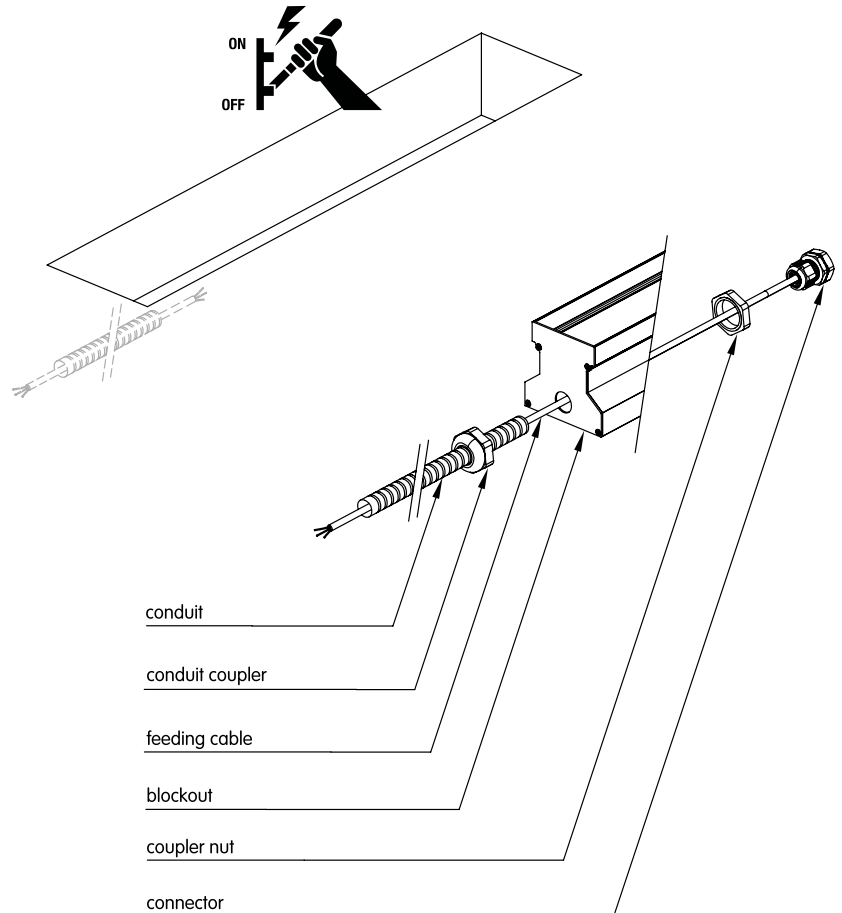

3. HOUSING INSTALLATION

- ▶ When installed in an existing slab, make sure to leave at least a 1" (25mm) gap around the housing to secure housing by pouring mortar and filling the gap.
- ▶ For installation in soft ground or dirt, leave 3" to 4" gap around the housing to secure with concrete.
- ▶ Before Laying the housing in the ground make sure to cover it with the temporary pouring SPACER (Housing Cover) provided with housing. Prevent any debris from getting into the housing.
- ▶ The same above steps apply to the shallow housing as shown in figures on the left.
- ▶ For continuous runs place housings end-to-end making sure no debris falls between the consecutive housings.
- ▶ Once the housings are placed in proper locations, secure them together with the screws and nuts provided with housings. Make sure there are no gaps between the housings.
- ▶ Follow instructions on next page for correct leveling of housing in ground.



WARNING: Shock hazard.
Serious injury or death may occur.
Turn Off power before servicing or installing.
Wire according to local and national codes. This product shall be installed by a qualified electrician.



3. HOUSING INSTALLATION

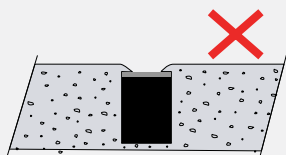

Housing must never be installed below ground level.

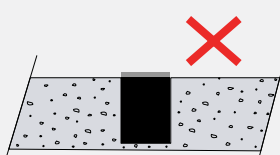

Housing must never be protude from ground level.

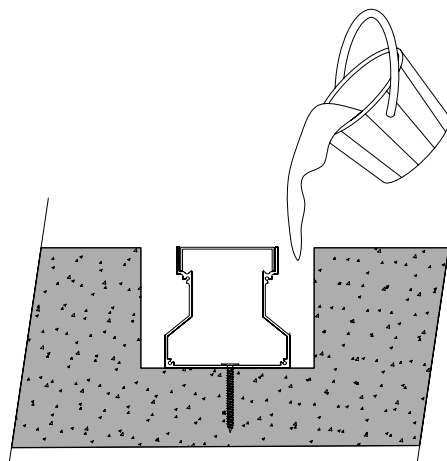
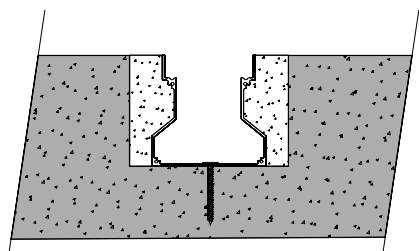
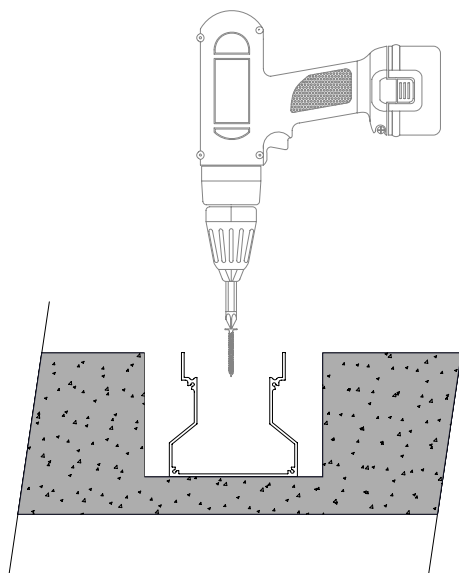
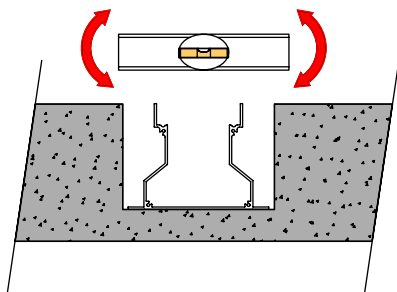

Housing spacer should be used during installation to avoid housing apreture being deformed by accident.

4. WIRING INSTRUCTIONS

- Refer to the last page for wiring instructions.
- Follow carefully wiring diagram for various dimming protocols.
- Before beginning the wiring process, double check the type of connection specified.

T1 Type fixture only have an input, and cannot be used for daisy chained fixtures.

CONTINUOUS RUNS

T2 Type fixtures have though wiring and are meant to be daisy chained.

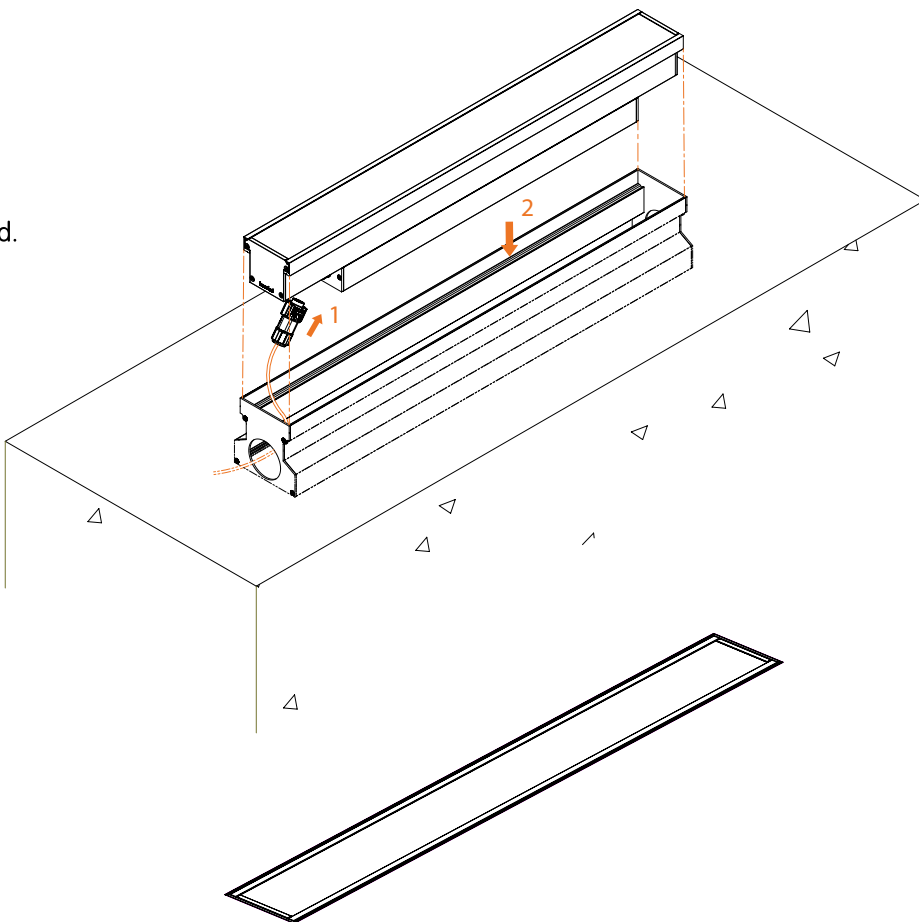

Wiring Color Codes

	Ground	Line	Neutral	Dimmed Line	0-10V +	0-10V -	Dali +	Dali -
UL System	Green	Black	White	Orange	Red	Grey	Red	Orange
CE System	Yellow/Green	Brown	Blue	N/A	Red	Black	Red	Black



WARNING: Do not exceed the rated wattage of the through wiring cables or the connectors.
For all continuous runs, refer to factory shop drawing indicating exact dimensions and feed locations.

5. CONTINUOUS RUN INSTALLATION

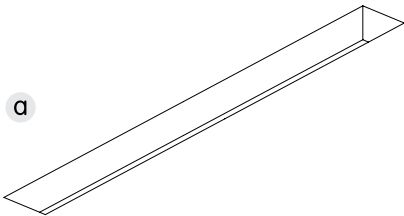

- Prepare ground hole.
- Insert all blockouts.
- Pour material into ground according to steps 1-7 in single unit sheet.

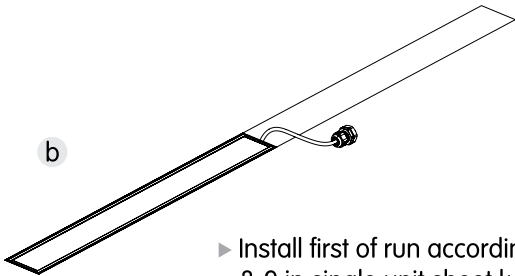

- Install first of run according to steps 8-9 in single unit sheet keeping the through wiring cable accessible.

- Connect the through wiring cable to the following luminaire.

- 1 ► Tuck the connector into the blockout side pockets.
- 2 ► Insert luminaire into blockout.

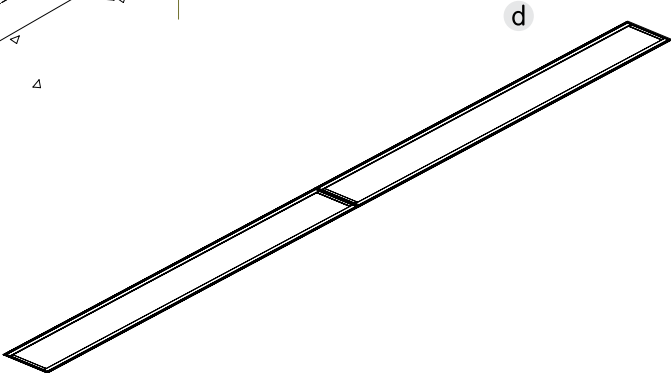
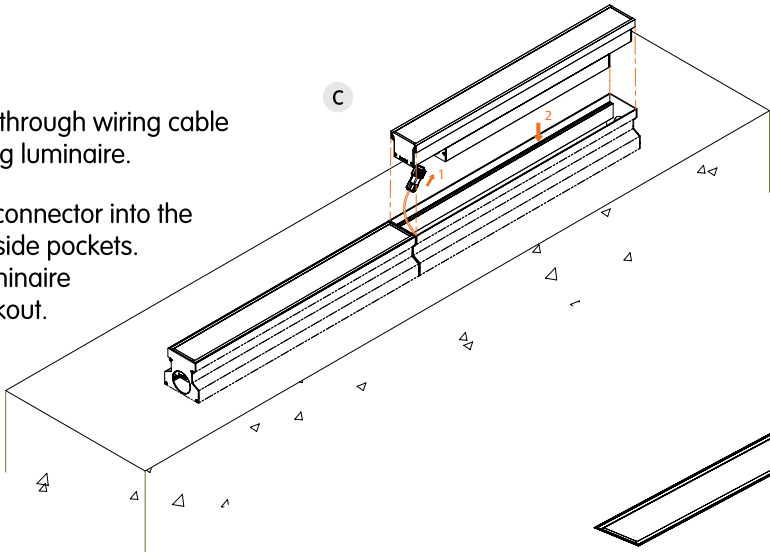

Wiring Instructions for continuous runs (Daisy Chained Fixtures)

Max daisy chain length (A minimum of 18 AWG or 0.752 mm is required)

System	Voltage	"L" Output	"S" Output	"H" Output	"W" & "T" Outputs
UL	120VAC - 60 Hz	100 ft.	50 ft.	36 ft.	50 ft.
	277VAC - 60 Hz	200 ft.	100 ft.	70 ft.	100 ft.
CE	240VAC - 50/60 Hz	45m	23m	17m	23m



WARNING: Do not exceed the rated wattage of the through wiring cables or the connectors.
For all continuous runs, refer to factory shop drawing indicating exact dimensions and feed locations.

LINE-TO-LINE CONNECTOR:

When Provided with Line-to-Line Connectors, fixtures will be Type 2 (Daisy chained) as show on page 3 and will have an Input cable and an Output cable with specific length. These Cables shall be connected and terminated On-site.

Line-to-Line Connectors will have a separate instruction manual included in the fixture's packaging, giving detailed instructions on how to connect the leads properly. This step requires following the below wire labeling closely to prevent any damage to the fixtures.

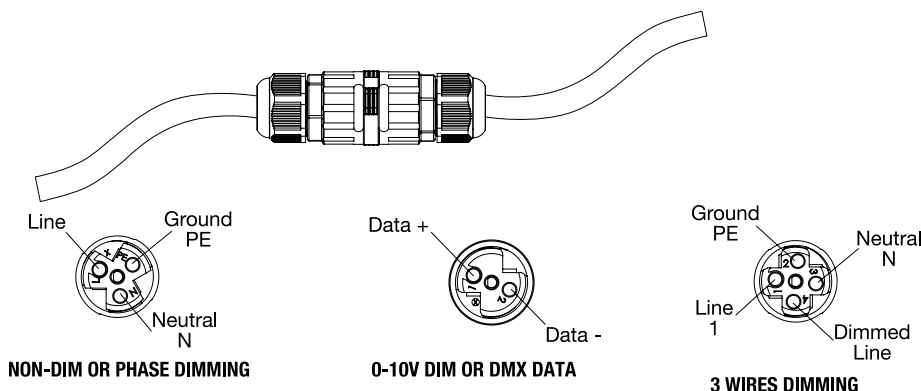

⚠ Failure to follow the wiring color coding and connectors pin labeling will void the fixtures warranty.

⚠ For 0-10v dimming, the fixture are provided with two (2) cable leads, one with a 3 pin connector for power and the other with 2 pins connector for dimming wires. follow below connector labeling for termination of wires.

MALE / FEMALE

When fixtures are ordered for continuous runs, (Daisy Chained), fixtures will be provided with MALE / FEMALE Connectors.

Connectors are factory installed on Input and Output cables leads.

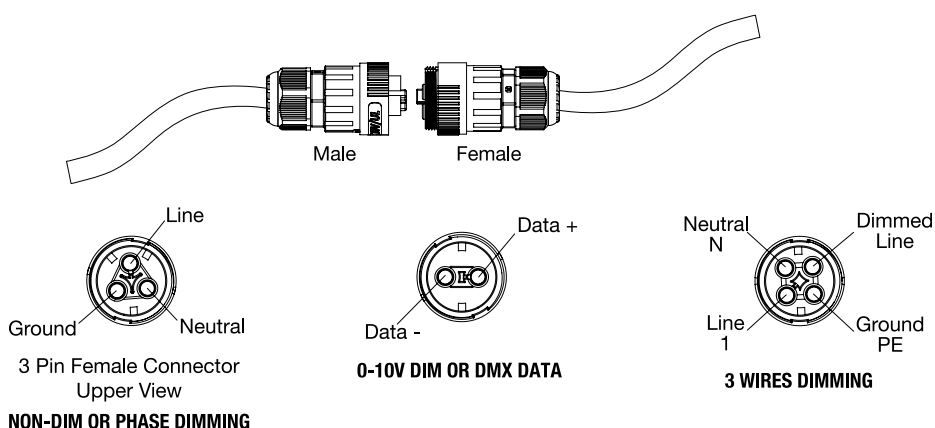

⚠ Failure to follow the wiring color coding and connectors pin labeling will void the fixtures warranty.

⚠ WARNING: The connectors pins labeling can be found inside connector, embossed on the wire terminals. Always double check factory wiring order before connecting terminating the cables on-site.